

## Joint 30

Joint with adjustable friction. Creates an articulated link between two profiles or surface elements; use the screw to infinitely vary the joint's friction resistance or to fasten the joint at a defined position.

Note: On-site mount.

**System:** 30 - Slot 6

**Type:** Joints



Joint loads

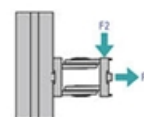

Type	F1 (N)	F2 (N)
Joint 20	500	200
Joint 30	6000	500

## General Data

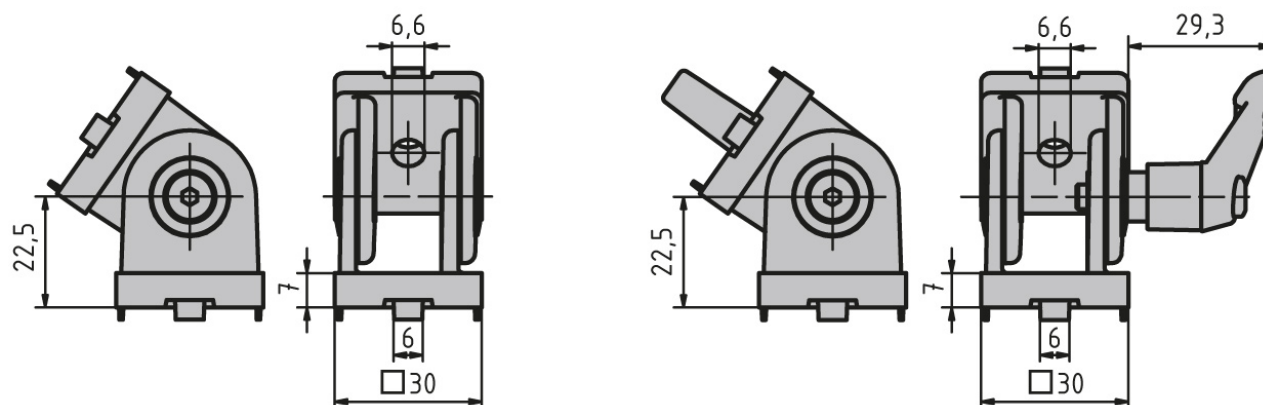

Designation	Description	System	Material
<b>PZ3200</b>	Joint 30	30 - Slot 6	Aluminium coloured die-cast zinc
<b>PZ3205</b>	Joint 30 with clamping lever	30 - Slot 6	Aluminium coloured die-cast zinc