

## Central Fastener 40 90°

### Application:

Fastener for 90° mitered joint, cut angle is 45°

### Assembly:

Bore hole for the barrel housing (2x): Ø 12 mm, 38 mm from profile end, 30 mm deep.

Bore for center hole on end of profile for anchor (2x): Ø 8.5 mm, 50 mm deep; Ø 10 mm, 26 mm deep.

**System:** 40 - Slot 8

**Type:** Fasteners

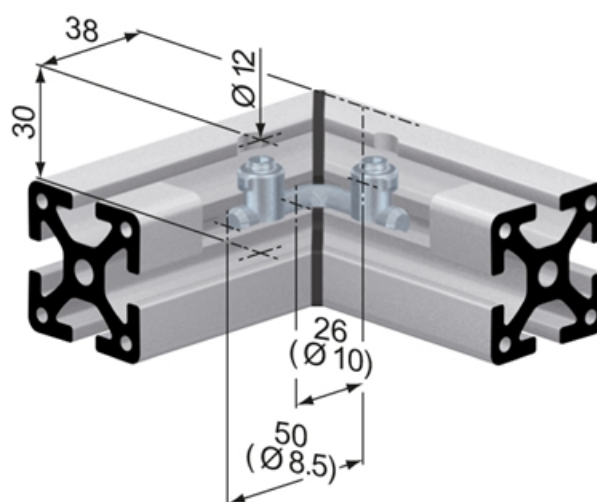
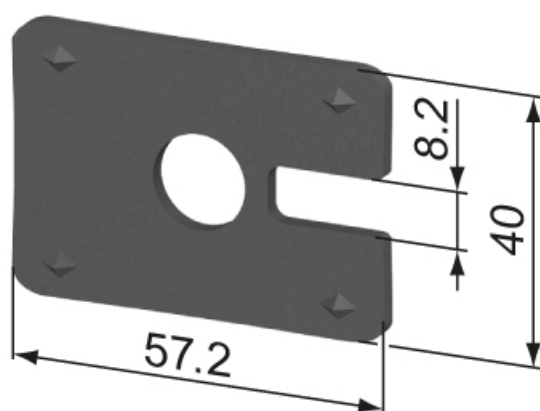
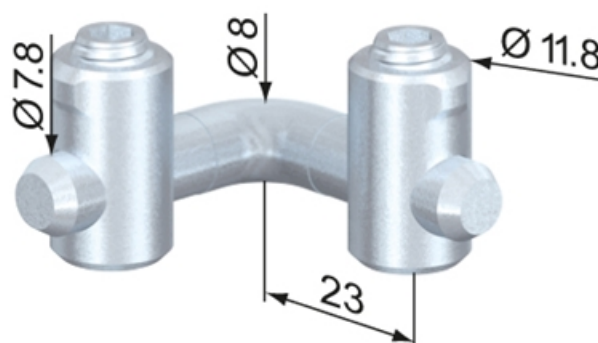

## General Data

Designation	Description	System	Material	Weight (g)
<b>SV1650V</b>	Central Fastener 40 90°	40 - Slot 8	Steel, zinc-plated	42
<b>SV1660V</b>	Plastic Corner 40 90°	40 - Slot 8	POM, black	8